

Assembly Instructions

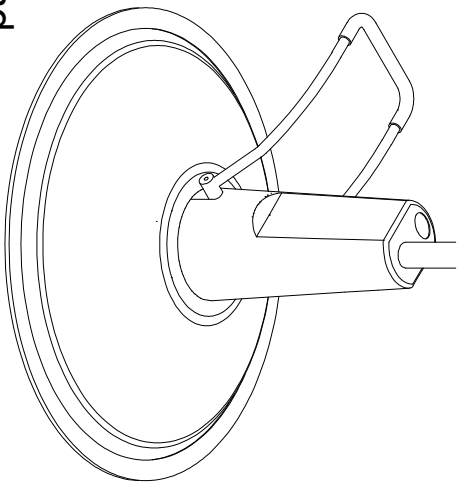

Oversize base and hydraulic instructions

PARTS LIST*		
Part	Qty.	Description
A	1	Base
B	1	Hydraulic
C	4	Nut
D	1	Hydraulic Lever
E	2	Lever Bolt

*Open all boxes to check for parts before beginning assembly.

**All bolt/washer sets are already in the brackets and footrest.

Tools required:

Allen wrench (included)



1) Hydraulic Lever Assembly

1) Insert hydraulic lever(D) into the holes in the hydraulic(B) and insert two lever bolts(E) into the holes as shown.

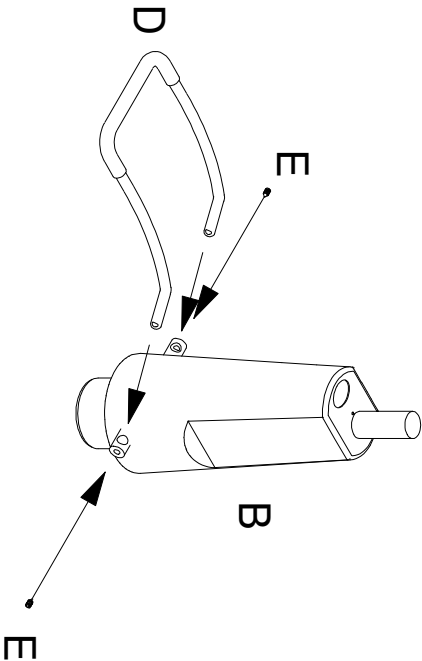

2) Hydraulic and Base Assembly

1) Insert hydraulic(B) into the base(A) and screw four nuts(C) into the center as shown below.

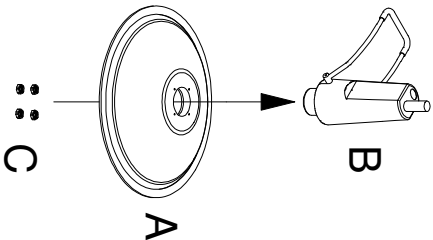

*Pump must be primed before using. Failure to do so may result in premature hydraulic failure. To prime, raise and lower hydraulic ten times before use.